

PLASTIC CENTRIFUGAL PUMP

CENTRIFUGAL PUMPS SERIES 144



FEATURES

- Chemical resistant construction
- Body and Adapter made of non-metallic glass reinforced Nylon 6/6
- Impeller made of non-metallic glass reinforced PPS
- Mechanical Seal - carbon / ceramic faces, silicone rubber elastomer
- Tolerates intermittent dry running
- Barbed -Hose Connections
- Static Nitrile O-Ring body/adapter seal
- Integrated Air Vent - prevents loss of prime
- Compact and Lightweight
- Installation/Mounting Versatility - port orientation
- Universal - Open Drip Proof Motors with internal fan cooling, UL listed
- No 18 Wire leads - 25" long
- Low amperage
- 120VAC, 240VAC (Optional: double insulation) and 12VDC versions.

DRIVE

One of the outstanding features of this pump is its compact A.C. or D.C. motor size. The motors are ODP with an internal cooling fan and are UL listed and is rated for continuous duty. Rotation is clockwise from shaft. 50 Hz is permitted. There is a #6-32 tapped hole ground connection provided on the end of metal framed motors.

LIQUIDS AND TEMPERATURE

Maximum fluid temperature is 180° F (82.2° C). Fluids must be compatible with silicone rubber seal elastomer. To promote long product life, assure that ambient air can circulate around the unit to prevent over-heating. Ground metal frame motors.

PERFORMANCE

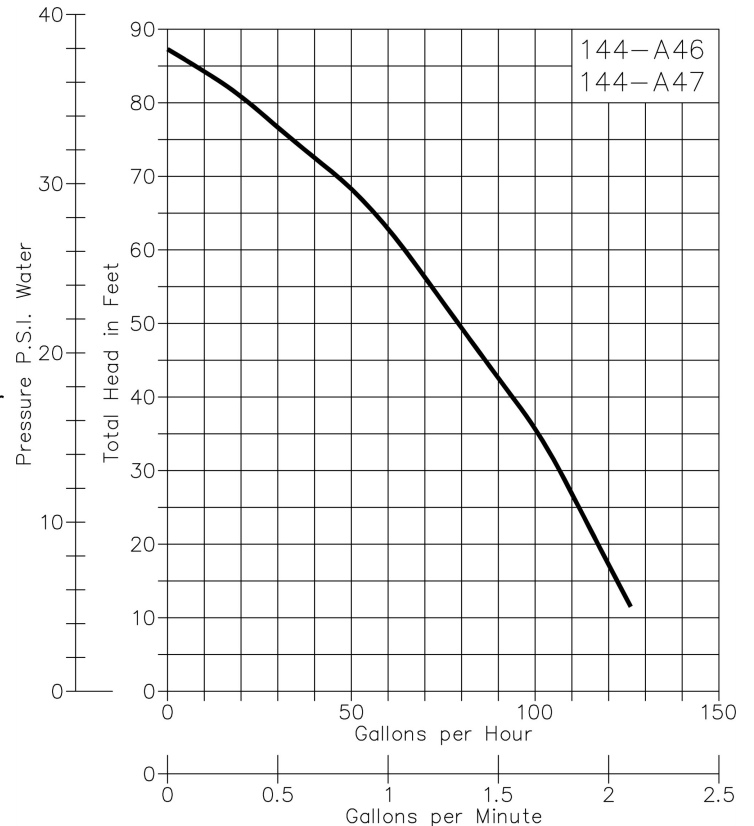

SUCTION LIFT

Prevent air trapping in plumbing lines by avoiding loops. Use air vent fitting connection to purge air. Though capable of pulling slight vacuum, the pump performs best under flooded suction conditions when located for gravity feed.

An optional air vent fitting prevents loss of prime that can occur due to entrapped air. It is factory installed with a disposable vent cap. Entrapped air can be encountered in applications where the liquid in the supply tank is completely exhausted. Air can be introduced to the system before the next tank filling.

For best results, configure and install pump with air vent near the top.

EXPLODED VIEW AND PARTS LIST

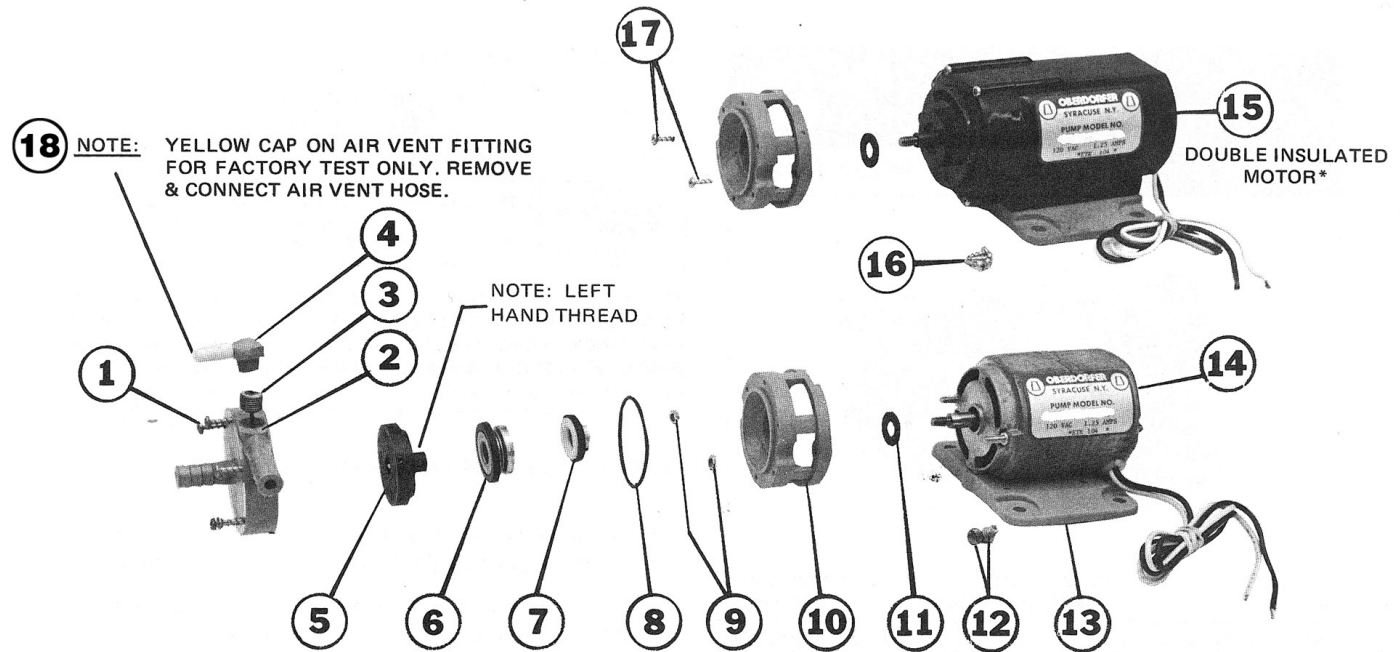

1	2	3	4	5	6	7	8	9	10	11	12	13	14	15	16	17	18
SCREW	BODY	PLUG	VENT FITTING	IMPELLER	SEAL HEAD	SEAL SEAT	O-RING	NUT	ADAPTER	SLINGER	SCREW	BASE	MOTOR	MOTOR	SCREW	SCREW	VENT CAP
6 Req'd	1 Req'd	1 Req'd	1 Req'd	1 Req'd	1 Req'd	1 Req'd	1 Req'd	2 Req'd	1 Req'd	1 Req'd	2 Req'd	1 Req'd	1 Req'd	1 Req'd	4 Req'd	2 Req'd	1 Req'd

Pump	1	2	3	4	5	6	7	8	9	10	11	12	13	14	15	16	17	18
144- 22	7819	7752	7835	--	8900	8421	3109/5863	7818		8455	6651		8367					--
144- 23																		
144- 01																		
144- 02																		
144- 04	7819	7752	--	7799	8900	8421	3109/5863	7818		8455	6651		8367					7879
144- 05																		
144- 11																		
144- 21																		
144- 10	7819	7752	--	7799	8900	8421	3109/5863	7818		8455	6651		--					7879
144- 20																		
Motor																		
A44									7823			7821	8370	--	--	--	--	--
A46									--			--	--	8516	8450	9200	--	--
A47									--			--	--	8517	8450	9200	--	--
A91									--			--	--	2057	8450	9200	--	--

Repair Kits:

Complete Pump Repair Kit (less motor)
Body Kit
Adapter Kit
Impeller Kit

Kit

11336 includes items 1,2,3,4,5,6,7,8,9,10,11,17,18
11337 includes items 1,2,3,4,8,18
11338 includes items 1,7,8,9,10,11,17
11339 includes items 5,6,8

